

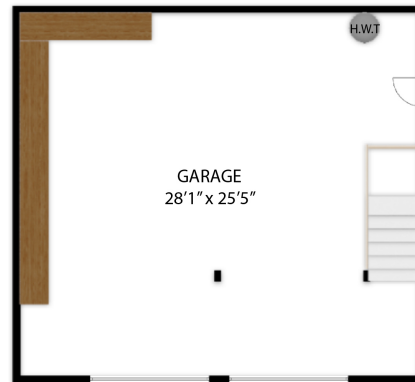

FIRST FLOOR



BASEMENT

427 Sumner Avenue, Aptos, CA, 95003
TOTAL APPROX. FLOOR AREA 2,992 SQ.FT

Whilst every attempt has been made to ensure the accuracy of the floor plan contained here, measurements of doors, windows, rooms and any other items are approximate and no responsibility is taken for any error, omission, or misstatement. This plan is for illustrative purposes only and should be used as such by any prospective purchaser.